

WASHING MACHINE
AUTOMATICKÁ PRÁČKA
PRÁŁKA AUTOMATYCZNA
AUTOMATA MOSÓGÉP

INSTRUCTION BOOKLET NÁVOD OBSLUŽE INSTRUKCJA OBSŁUGI HASZNÁLATI UTMUTATÓ

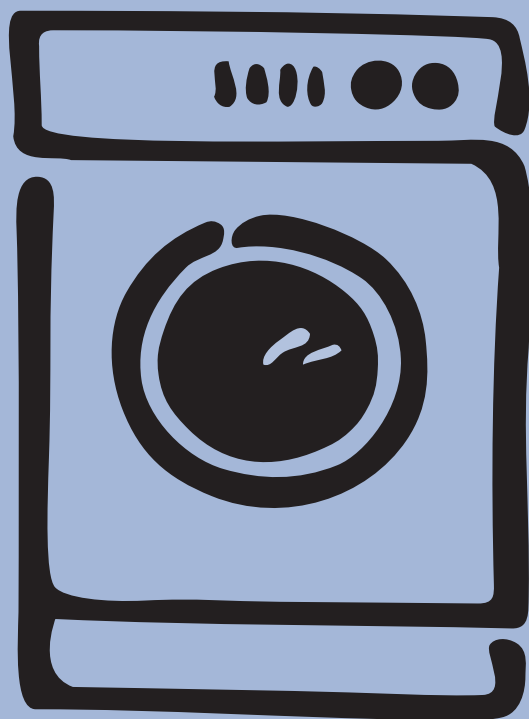

EW 934 S

GB

PL

CZ

H

124 974 531

 **Electrolux**

YOUR NEW WASHING MACHINE

This new washing machine meets all requirements for a modern washing of laundry with reduced consumption of water, energy and detergent.

- **The temperature selector dial** allows you to choose personally the suitable washing temperature for your laundry.
- **The automatic cooling** of the washing water from 95°C to 60°C before draining will prevent plastic pipes of your drainage system from being deformed.
- **The special wool programme** with its new delicate wash system treats your woollens with extreme care.

Ecological hints

In order to obtain water and energy savings and to protect the environment, we advice you to follow these instructions:

- Whenever possible, wash the maximum load for the selected programme, without overloading the drum.
- Use a programme with prewash only for heavy soiled items.
- Measure out detergent according to the water hardness, degree of soiling and quantity of laundry being washed.
- Select an "Economy wash" for normally soiled laundry.

Environment protection

■ Packaging recycling

Materials marked with the  symbol are recyclable. To enable them to be recycled, they must be placed in the appropriate collection areas (or containers). Check with your local authorities.

>PE<= polyethylene

>PS<= polystyrene

>PP<= polypropylene

■ Washing machine scrapping

When the appliance is to be scrapped, cut off the power supply cable and make the door closing device inoperative to avoid it becoming a death trap for a child.

For correct disposal of the machine, contact your local authority department which provides for collection of urban solid refuse.

The symbols you will see on some paragraphs of this booklet have the following meaning:



Important information concerning the safety in the use of your machine. Disregarding this information might lead to damages.



Information for correct use of your machine and to obtain the best performance.



Important information concerning environment protection.

Our contribution to the protection of the environment: we use recycled paper.

CONTENTS

Important information4

Description of the appliance5

- Detergent dispenser drawer and programme chart5

Technical specifications5

Installation6

- Unpacking6
- Positioning6
- Water inlet7
- Water drainage7
- Electrical connection7

Use8

- Control panel8
- Washing hints9
 - Sorting the laundry9
 - Temperatures9
 - Before loading the laundry9
 - Maximum loads9
 - Laundry weights9
 - Removing stains9
 - Detergents and additives10
 - Quantity of detergent to be used10
- International wash code symbols11
- Washing programmes12-13
- Operating sequence14-15

Maintenance16

- Bodywork16
- Detergent dispenser drawer16
- Water inlet filter16
- Drain pump17
- Emergency emptying out17
- The dangers of freezing17

Something not working18-19



IMPORTANT INFORMATION

It is important that this instruction book be kept with the appliance for future reference. If you sell or give the appliance away, make sure that the book is passed to the new owners so that they can familiarise themselves with its operation and relevant warnings.

The following warnings are provided in the interests of overall safety. You must read them carefully before installing or using the appliance.

Installation

- When unpacking the appliance, check that it is not damaged. If in doubt, do not use it and contact the Service Centre.
- All internal packing must be removed before using the appliance. Serious damage may be caused to the machine or adjacent furniture if the protective transit devices are not removed or are not completely removed. Refer to the relevant paragraph in the instruction book.
- Any electrical work required to install this appliance must be carried out by a qualified electrician.
- Any plumbing work required to install this appliance must be carried out by a qualified plumber.
- After having installed the machine, check that it is not standing on its electrical supply cable.
- If the appliance is placed on a carpeted floor, ensure that air can circulate freely between the adjustable feet and the floor.

Use

- This appliance is designed for domestic use. It must not be used for purposes other than those for which it was designed.
- Do not overload the appliance. Follow the instructions in the instruction book.
- Only wash fabrics which are designed to be machine washed. Follow the instructions on each garment label.
- Make sure that all pockets are empty. Objects such as coins, safety pins, pins and screws can cause extensive damage.
- Do not machine wash garments saturated with petroleum, methylated spirits, trichlorethylene, etc. If such fluids have been used to remove stains prior to washing, wait until they have completely evaporated from the fabric before placing garments in the appliance.

- Place small items such as socks, belts, etc. in a cloth bag or pillowcase to prevent them getting trapped between the drum and the tub.
- Use only the recommended quantities of fabric softener. An excessive amount could damage the laundry.
- Leave the porthole door slightly ajar when the appliance is not in use. This preserves the door seal and prevents the formation of musty smells.
- Always check that water has emptied out before opening the door. If not, drain the water following the instructions in the instruction book.
- Always unplug the appliance and shut the water tap after use.

Service/repair

- In the event of a fault, do not attempt to repair the appliance yourself. Repairs carried out by inexperienced persons may cause damage.
- If repairs are needed, contact an authorised service centre and ask for genuine spare parts.

Safety

- This appliance is designed to be used by adults. Children must not be allowed to touch the controls or play with the product.
- During high temperature wash cycles the glass door becomes very hot. Do not touch it.
- Pets sometimes climb into washing machines. Check the drum before each use.

DESCRIPTION OF THE APPLIANCE

- 1 Detergent dispenser drawer
- 2 Programme chart
- 3 Operating pilot light
- 4 ON/OFF button
- 5 Option buttons
- 6 Door locked light
- 7 Door opening button
- 8 Temperature selector dial
- 9 Programme selector dial
- 10 Adjustable feet

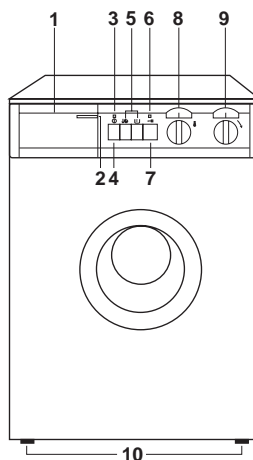

Detergent dispenser drawer and programme chart

Symbols

- Prewash
 Main wash
 Fabric softener

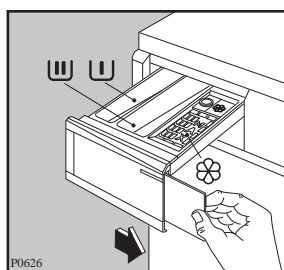

Programme chart

There is a programme guide in symbols in the interior part of the detergent dispenser drawer.

TECHNICAL SPECIFICATIONS

DIMENSIONS

Height	85 cm
Width	60 cm
Depth	32 cm

POWER SUPPLY VOLTAGE/FREQUENCY

220-230V/50 Hz

TOTAL POWER ABSORBED

1700 W

MINIMUM FUSE PROTECTION

10 A

WATER PRESSURE

Minimum	5 N/cm ²
Maximum	80 N/cm ²

MAXIMUM LOAD

Cotton	3.5 kg
Synthetics, delicate fabrics	1 kg
Woollens	0.7 kg

SPIN SPEED

900 rpm



This appliance complies with the following EEC Directives:
 73/23/EEC of 19/02/73 relating to low voltage
 89/336/EEC of 03/05/89 relating to electromagnetic compatibility

INSTALLATION

Unpacking



All transit bolts and packing must be removed before using the appliance.

You are advised to keep all transit devices so that they can be refitted if the machine ever has to be transported again.

1. Using a spanner, unscrew and remove the rear right-hand bolt and lay the machine on its back, taking care not to squash the hoses. This can be avoided by placing one of the corner packing pieces between the machine and the floor.

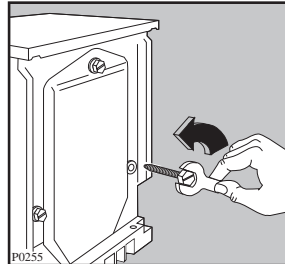

2. Release the two plastic bags by removing the adhesive strip.
3. Carefully remove the right-hand bag (1) then the left-hand bag (2) by pulling them towards the centre of the machine.

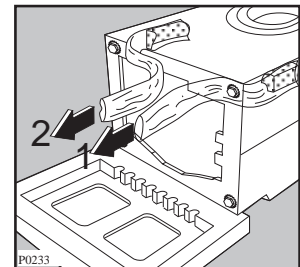
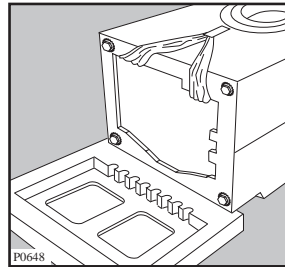

4. Set the machine upright and remove the two remaining bolts from the back.
5. Pull out the three plastic spacers from the holes into which the bolts were fitted.
6. Plug the open holes with the plugs which you will find in the plastic bag containing the instruction booklet.

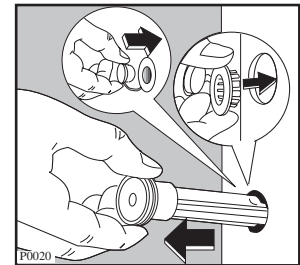
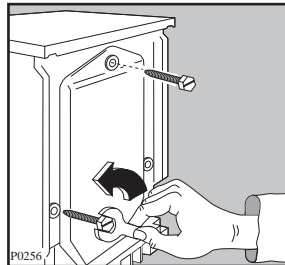

Positioning

Install the machine on a flat hard floor. Make sure that air circulation around the machine is not impeded by carpets, rugs etc. Check that the machine does not touch the wall or other kitchen units. Carefully level by screwing the adjustable feet in or out. Never place cardboard, wood or similar materials under the machine to compensate for any unevenness in the floor.

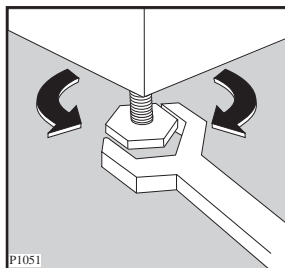

Water inlet

Connect the water inlet hose to a tap with a 3/4" thread after having inserted the small filter "A" supplied with the machine.

The other end of the inlet hose which connects to the machine can be turned in any direction. Simply loosen the fitting, rotate the hose and retighten the fitting, making sure there are no water leaks.

The inlet hose must not be lengthened. If it is too short and you do not wish to move the tap, you will have to purchase a new, longer hose specially designed for this type of use.

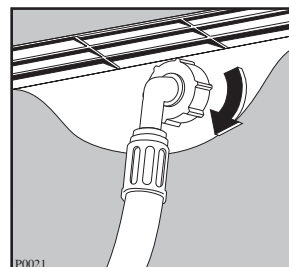
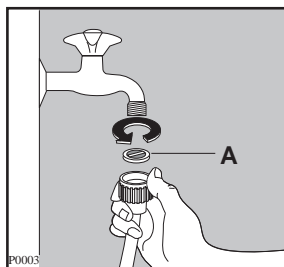

Water drainage

The end of the drain hose can be positioned in three ways:

Hooked over the edge of a sink using the plastic hose guide supplied with the machine. In this case, make sure the end cannot come unhooked when the machine is emptying.

This could be done by tying it to the tap with a piece of string or attaching it to the wall.

In a sink drain pipe branch. This branch must be above the trap so that the bend is at least 60 cm above the ground.

Directly into a drain pipe at a height of not less than 60 cm and not more than 90 cm.

The end of the drain hose must always be **ventilated**, i.e. the inside diameter of the drain pipe must be larger than the outside diameter of the drain hose.

The drain hose must not be kinked. Run it along the floor; only the part near the drainage point must be raised.

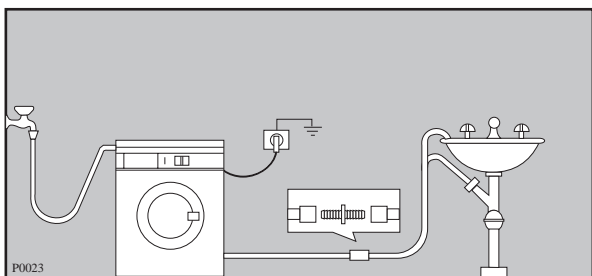
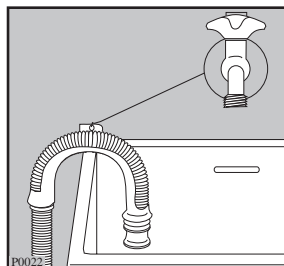

Electrical connection

This machine is designed to operate on a 220-230 V, single-phase, 50 Hz supply.

Check that your domestic electrical installation can take the maximum load required (1.75 kW), also taking into account any other appliances in use.

Connect the machine to an earthed socket.



In the event of replacing the electric cable, please contact our nearest Service Centre.



The manufacturer declines any responsibility for damage or injury through failure to comply with the above safety precaution.

USE

Control panel

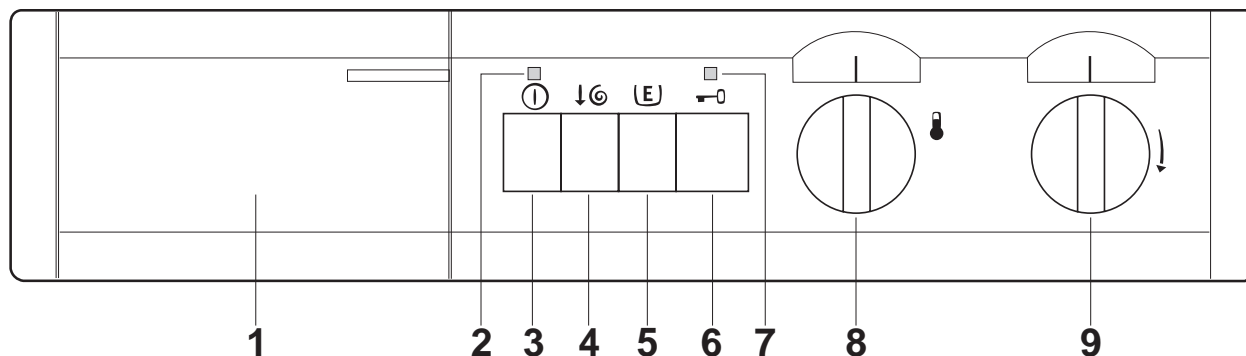

1 Detergent dispenser drawer

2 Operating pilot light

This light is on whilst the machine is operating and goes out when the machine is switched off by depressing ON/OFF button again.

3 ON/OFF button ①

By depressing this button the machine is switched on. By depressing it again the machine is switched off.

4 Spin speed reduction button ↓Ⓢ

By depressing this button the spin speed is reduced from 900 to 650 rpm in the cotton programmes and from 650 to 550 rpm in programme L (Short spin).

5 Economy button (E)

This button can be used with programmes B and G by selecting 40°-60° instead of 60°-95° and 30°-40° instead of 40°-60°: the washing time will be slightly longer to compensate for the reduction in temperature.

To be used for normally soiled laundry, in order to save energy.

6 Door opening button ➡

Depress it to open the door.

7 Door locked pilot light

The door stays locked throughout the wash cycle. Locking is indicated by this pilot light. The door can not be opened until the pilot light has gone out.

8 Temperature selector dial

Turn this dial to select the washing temperature. Position ✕ = cold wash.

9 Programme selector dial

To select the required programme, turn this dial **clockwise** until the programme letter is exactly opposite the pointer.

Before selecting a programme or changing a programme in progress the machine must be switched off by depressing ON/OFF button.

Washing hints

Sorting the laundry

Follow the wash code symbols on each garment label and the manufacturer's washing instructions.

Sort the laundry as follows:
whites, coloureds, synthetics, delicates, woollens.

Temperatures

95° for normally soiled white cottons and linen (e.g. tea cloths, towels, tablecloths, sheets...)

60° for normally soiled, colour fast garments (e.g. shirts, night dresses, pyjamas....) in linen, cotton or synthetic fibres and for lightly soiled white cotton (e.g. underwear)

✕ (cold) for delicate items (e.g. net curtains),
30°-40° mixed laundry including synthetic fibres and woollens bearing the label «pure new wool, machine washable, non-shrink».

Before loading the laundry

Never wash whites and coloureds together. Whites may lose their "whiteness" in the wash.

New coloured items may run in the first wash; they should therefore be washed separately the first time.

Make sure that no metal objects are left in the laundry (e.g. hair clips, safety pins, pins).

Button up pillowcases, close zip fasteners, hooks and poppers. Tie any belts or long tapes.

Remove persistent stains before washing. Rub particularly soiled areas with a special detergent or detergent paste.

Treat curtains with special care. Remove hooks or tie them up in a bag or net.

Maximum loads

Recommended loads are indicated in the programme charts.

General rules:

cotton, linen: drum full but not too tightly packed

synthetics: drum no more than half full

delicate fabrics and woollens: drum no more than one third full.

Washing a maximum load makes the most efficient use of water and energy.

For heavily soiled laundry, reduce the load size.

Laundry weights

The following weights are indicative:

bathrobe	1200 g
napkin	100 g
quilt cover	700 g
sheet	500 g
pillow case	200 g
tablecloth	250 g
towelling towel	200 g
tea cloth	100 g
night dress	200 g
ladies' briefs	100 g
man's work shirt	600 g
man's shirt	200 g
man's pyjamas	500 g
blouse	100 g
men's underpants	100 g

Removing stains

Stubborn stains may not be removed by just water and detergent. It is therefore advisable to treat them prior to washing.

Blood: treat fresh stains with cold water. For dried stains, soak overnight in water with a special detergent then rub in the soap and water.

Oil based paint: moisten with benzine stain remover, lay the garment on a soft cloth and dab the stain; treat several times.

Dried grease stains: moisten with turpentine, lay the garment on a soft surface and dab the stain with the fingertips and a cotton cloth.

Rust: oxalic acid dissolved in hot water or a rust removing product used cold. Be careful with rust stains which are not recent since the cellulose structure will already have been damaged and the fabric tends to hole.

Mould stains: treat with bleach, rinse well (whites and fast coloureds only).

Grass: soap lightly and treat with bleach (whites and fast coloureds only).

Ball point pen and glue: moisten with acetone (*), lay the garment on a soft cloth and dab the stain.

Lipstick: moisten with acetone as above, then treat stains with methylated spirits. Remove any residual marks from white fabrics with bleach.

Red wine: soak in water and detergent, rinse and treat with acetic or citric acid, then rinse. Treat any residual marks with bleach.

Ink: depending on the type of ink, moisten the fabric first with acetone (*), then with acetic acid; treat any residual marks on white fabrics with bleach and then rinse thoroughly.

Tar stains: first treat with stain remover, methylated spirits or benzine, then rub with detergent paste.

(*) do not use acetone on artificial silk.

Detergents and additives

Good washing results also depend on the choice of detergent and use of the correct quantities to avoid waste and protect the environment. Although biodegradable, detergents contain substances which, in large quantities, can upset the delicate balance of nature.

The choice of detergent will depend on the type of fabric (delicates, woollens, cottons, etc.), the colour, washing temperature and degree of soiling.

All commonly available washing machine detergents may be used in this appliance:

- powder detergents for all types of fabric,
- powder detergents for delicate fabrics (60°C max) and woollens,
- liquid detergents, preferably for low temperature wash programmes (60°C max) for all types of fabric, or special for woollens only.

The detergent and any additives must be placed in the appropriate compartments of the dispenser drawer before starting the wash programme.

If using concentrated powder or liquid detergents, a programme **without** prewash must be selected.

Pour liquid detergent into the dispenser drawer compartment marked  **just before** starting the programme.

Any fabric softener or starching additives must be poured into the compartment marked  before starting the wash programme.

Follow the product manufacturer's recommendations on quantities to use.

Quantity of detergent to be used

The type and quantity of detergent will depend on the type of fabric, load size, degree of soiling and hardness of the water used.

Water hardness is classified in so-called "degrees" of hardness. Information on hardness of the water in your area can be obtained from the relevant water supply company, or from your local authority.

Follow the product manufacturers' instructions on quantities to use.

Use less detergent if:

































- you are washing a small load,
- the laundry is lightly soiled,
- large amounts of foam form during washing.

Degrees of water hardness

Level	Characteristic	Degrees	
		German °dH	French °T.H.
1	soft	0- 7	0-15
2	medium	8-14	16-25
3	hard	15-21	26-37
4	very hard	more than 21	more than 37

i International wash code symbols

These symbols appear on fabric labels, in order to help you choose the best way to treat your laundry.

ENERGETIC WASH  DELICATE WASH 	 Max. wash temperature 95°C	 Max. wash temperature 60°C 	 Max. wash temperature 40°C  	 Max. wash temperature 30°C 	 Hand wash	 Do not wash at all
 BLEACHING	 Bleach in cold water		 Do not bleach			
 IRONING	 Hot iron max 200°C	 Warm iron max 150°C	 Lukewarm iron max 110°C	 Do not iron		
 DRY CLEANING	 Dry cleaning in all solvents	 Dry cleaning in perchlorethylene, petrol, pure alcohol, R 111 & R 113	 Dry cleaning in petrol, pure alcohol and R 113	 Do not dry clean		
 DRYING	 Flat	 On the line	 On clothes hanger	 high temperature  low temperature Tumble dry	 Do not tumble dry	

Energetic programmes for cotton and linen

Maximum load: 3.5 kg

Rated load: 3 kg

Progr.	Temp.	Type of laundry	Cycle description	Possible options
A	60°-95°	Whites with prewash (heavy soiled)	Prewash at 40°C Wash at 60°-95°C 4 rinses Long spin	↓🌀
B	60°-95°	Whites without prewash (normally soiled)	Wash at 60°-95°C 4 rinses Long spin	↓🌀
B+(E)	40°-60°	Whites economy (normally soiled)	Wash at 40°-60°C 4 rinses Long spin	↓🌀
C(*)	30°-60°	Coloureds without prewash (normally soiled)	Wash at 30°-60°C 4 rinses Long spin	↓🌀
D		Rinses	4 rinses with liquid additives, if required Long spin	↓🌀
F		Spin	Drain and long spin	↓🌀

The temperatures indicated are the optimum temperatures for each programme and depend on the type of laundry and degree of soiling.

(*) Consumptions for washing 3 kg cotton items at 60°C:

Water 55 litres



Energy 1.05 kWh

Time 120 mins

This data has been calculated with a temperature of incoming water of 15°C.

Gentle programmes for synthetics, mixed fibres, delicates and woollens

Maximum load: 1 kg, woollens: 0.7 kg

Progr.	Temp.	Type of laundry	Cycle description	Possible options
G	40°-60°	Synthetics without prewash (normally soiled)	Wash at 40°-60°C 3 rinses Stop with water left in the drum	
G+	30°-40°	Synthetics economy (normally soiled)	Wash at 30°-40°C 3 rinses Stop with water left in the drum	
H	30°-40°	Delicate fabrics - Silk	Wash at 30°-40°C 3 rinses Stop with water left in the drum	
J	30°-40°	Woollens 	Wash at 30°-40°C 3 rinses Stop with water left in the drum	
K		Rinses	3 rinses with fabric softener Stop with water left in the drum	
L		Short spin	Drain and short spin	
M		Drain	Draining of water	

The temperatures indicated are the optimum temperatures for each programme and depend on the type of laundry and degree of soiling.

The water of the last rinse of these programmes is not emptied out to avoid any creasing in the clothes. To drain water, select programme **M** (drain) or **L** (short spin).

i Operating sequence

*Before washing your first load of laundry, we recommend that you run a cotton cycle at 60°C, **with the machine empty**, in order to remove any manufacturing residue from the drum and tub.*

Pour half a measure of detergent into the main wash compartment and start up the machine.

1. Place the laundry in the drum

Open the door by depressing button . Place the laundry in the drum, one item at a time, shaking them out as much as possible. Close the door.

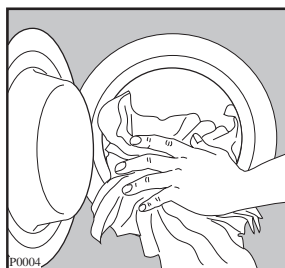

2. Measure out the detergent

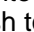
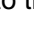
Pull out the dispenser drawer until it stops. Measure out the amount of detergent recommended by the manufacturer in a graduated cup and pour it into the main wash compartment . If you wish to carry out a prewash, pour detergent into the appropriate compartment marked .

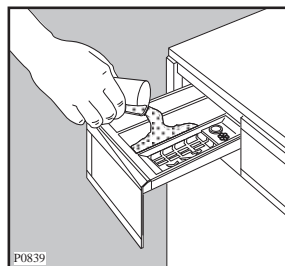

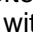

3. Measure out the additives

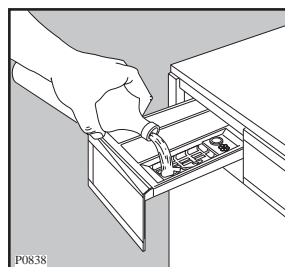
If required, pour fabric softener into the compartment marked  without exceeding the «MAX» mark.



4. Select the desired option(s)

Depress   and/or  button, if desired.

5. Select the temperature

Turn the selector dial to the required temperature setting.

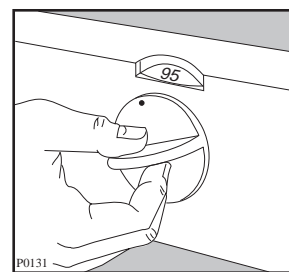
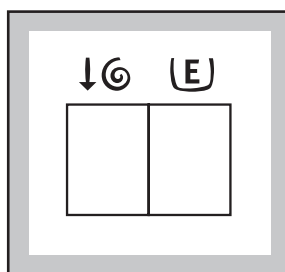

6. Select the programme and start it

Turn the programme selector dial clockwise to the required wash programme and depress the ON/OFF button: the operating pilot light and door locked light come on and the machine starts to operate.

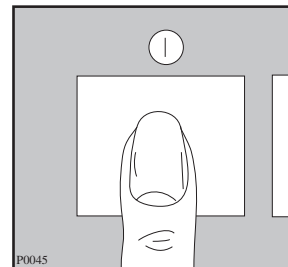
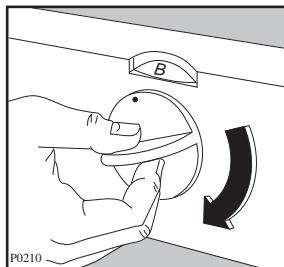

7. At the end of the programme

The machine stops automatically.

If you have selected a gentle programme which stops with water of the last rinse in the drum, drain the water before opening the door.

It is normal to have to wait for about 2 minutes before being able to open the door to allow the safety lock to release. The door can be opened when the door locked light is off.

Depress the ON/OFF button again to switch the machine off, the operating pilot light goes out.

Remove the laundry.

Turn the drum by hand to make sure it is completely empty, so as to avoid any forgotten items being damaged in a subsequent wash (e.g. shrinking) or their colour running into a load of whites.

Release any button which has been depressed.

Turn the water tap off and unplug the machine.

Leave the door ajar to air the machine.

MAINTENANCE

1. Bodywork

Clean the outside of the machine with warm water and a neutral, non-abrasive household detergent. Rinse with clean water and dry with a soft cloth.

Important: do not use methylated spirits, solvents or similar products to clean the bodywork.

2. Detergent dispenser drawer

After a while, detergents and fabric softeners leave deposits in the drawer.

Clean the drawer from time to time by rinsing it under a running tap. To remove the drawer from the machine, press the button in the rear left-hand corner.

To facilitate cleaning, the top part of the additive compartments can be removed.

Detergent can also eventually accumulate inside the drawer recess: clean it with an old toothbrush. Refit the drawer after cleaning.

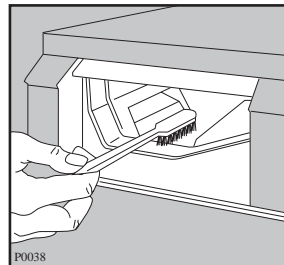
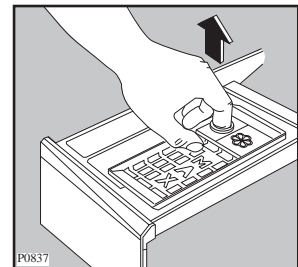
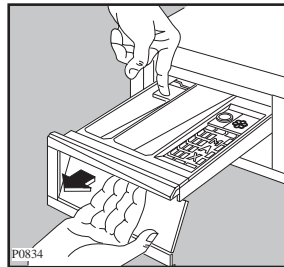

3. Water inlet filter

If you notice that the machine is taking longer to fill, check that the filter in the water inlet hose is not blocked.

Turn off the water tap.

Unscrew the hose from the tap and remove the filter.

Clean it with a stiff brush.

Refit the filter and screw the hose back onto the tap.

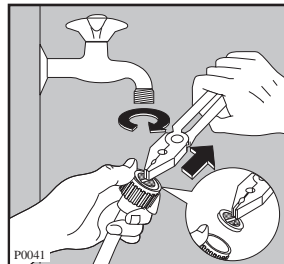

4. The drain pump

The machine is equipped with a self-cleaning pump which does not need any maintenance.

5. Emergency emptying out

If the water is not discharged proceed as follows to empty out the machine:

- pull out the plug from the power socket;
- close the water tap;
- if necessary, wait until the water has cooled down;
- place a bowl on the floor;
- put the drain hose end into the bowl and let the water come out.

6. The dangers of freezing

If the machine is exposed to temperatures below 0°C, certain precautions should be taken.

- Turn off the water tap.
- Unscrew the inlet hose.
- Unhook the drain hose from the rear support and position the end of this hose and that of the inlet hose in a bowl. Run the draining programme until the selector dial is in the "Stop" position.
- Switch the machine off.
- Screw the inlet hose and reposition the drain hose.
- When you intend to start the machine up again, make sure that the room temperature is above 0°C.

SOMETHING NOT WORKING

Problems which you can resolve yourself:

■ Problem	■ Possible cause
■ The machine does not start up:	<ul style="list-style-type: none"> ■ Check that the door is firmly closed. ■ Check that the machine is plugged in and that there is power at the socket. ■ Check that the main fuse has not blown. ■ Check that the programme selector dial is positioned correctly. ■ Check that the ON/OFF button is depressed.
■ The machine does not fill:	<ul style="list-style-type: none"> ■ Check that the water tap is open. ■ Check that water is coming out of the tap. ■ Check that the inlet hose is not squashed or kinked. ■ Check that the filter in the inlet hose is not blocked. ■ Check that the door is closed.
■ The machine fills then empties immediately:	<ul style="list-style-type: none"> ■ The end of the drain hose is too low. Refer to relevant paragraph in "water drainage" section.
■ The machine does not empty and/or does not spin:	<ul style="list-style-type: none"> ■ Check that the drain hose is not squashed or kinked. ■ A gentle programme which ends with water in the drum has been performed.
■ There is water on the floor:	<ul style="list-style-type: none"> ■ Too much detergent or unsuitable detergent (creates too much foam) has been used. ■ Check whether there are any leaks from one of the inlet hose fittings. It is not always easy to see this as the water runs down the hose; check to see if it is damp. ■ Check that the drain hose is not damaged.
■ Unsatisfactory washing results:	<ul style="list-style-type: none"> ■ Too little detergent or unsuitable detergent has been used. ■ Stubborn stains have not been treated prior to washing. ■ The correct temperature or programme was not selected.

■ Problem	■ Possible cause
■ The machine vibrates or is noisy:	<ul style="list-style-type: none"> ■ Check that all the transit bolts and packing have been removed. ■ Check that the machine is not resting against anything. ■ Check that the support feet are resting firmly on the ground. ■ Check that the laundry is evenly distributed in the drum. ■ Maybe there is very little laundry in the drum.
■ The door will not open:	<ul style="list-style-type: none"> ■ The programme is still running. ■ The door lock has not yet been released, the door locked light is on. ■ There is water in drum.
■ Spinning starts late or the machine does not spin:	<ul style="list-style-type: none"> ■ The electronic unbalance detection device has cut in because the laundry is not evenly distributed in the drum. The laundry is redistributed by reverse rotation of the drum. This may happen several times before the unbalance disappears and normal spinning can resume. If, after 10 minutes, the laundry is still not evenly distributed in the drum, the machine will not spin. In this case, redistribute the load manually and reselect the spin programme.
■ Water is not visible in the machine:	<ul style="list-style-type: none"> ■ The machine, which is the result of modern technology, runs in a very economical way with low water consumption. Performance is nevertheless excellent.

If you are unable to identify or solve the problem, contact our service centre. Before telephoning, make a note of the model, serial number and purchase date of your machine: the Service Centre will require this information.

